

# Kompressor T1-520

P300-00-92

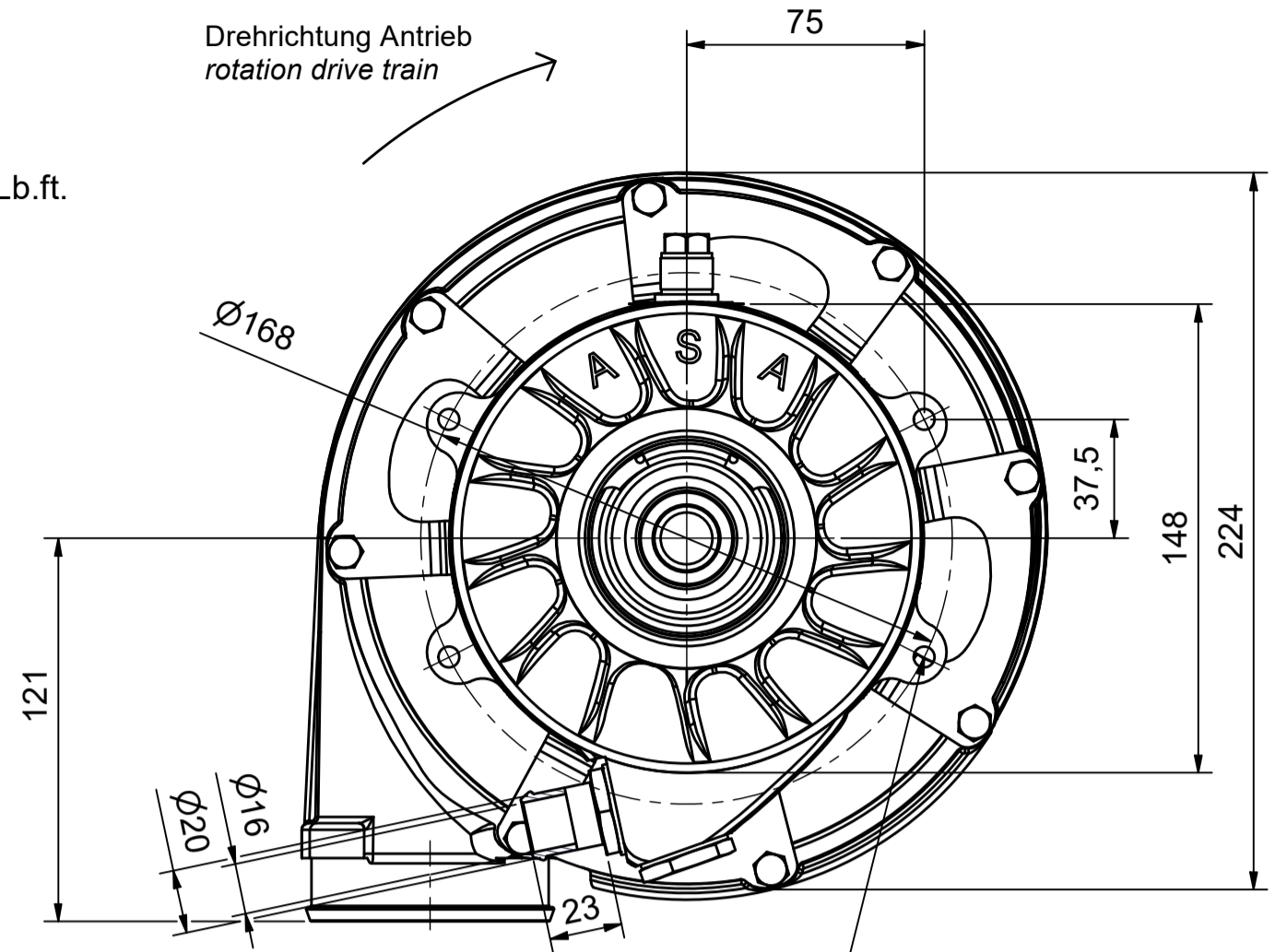
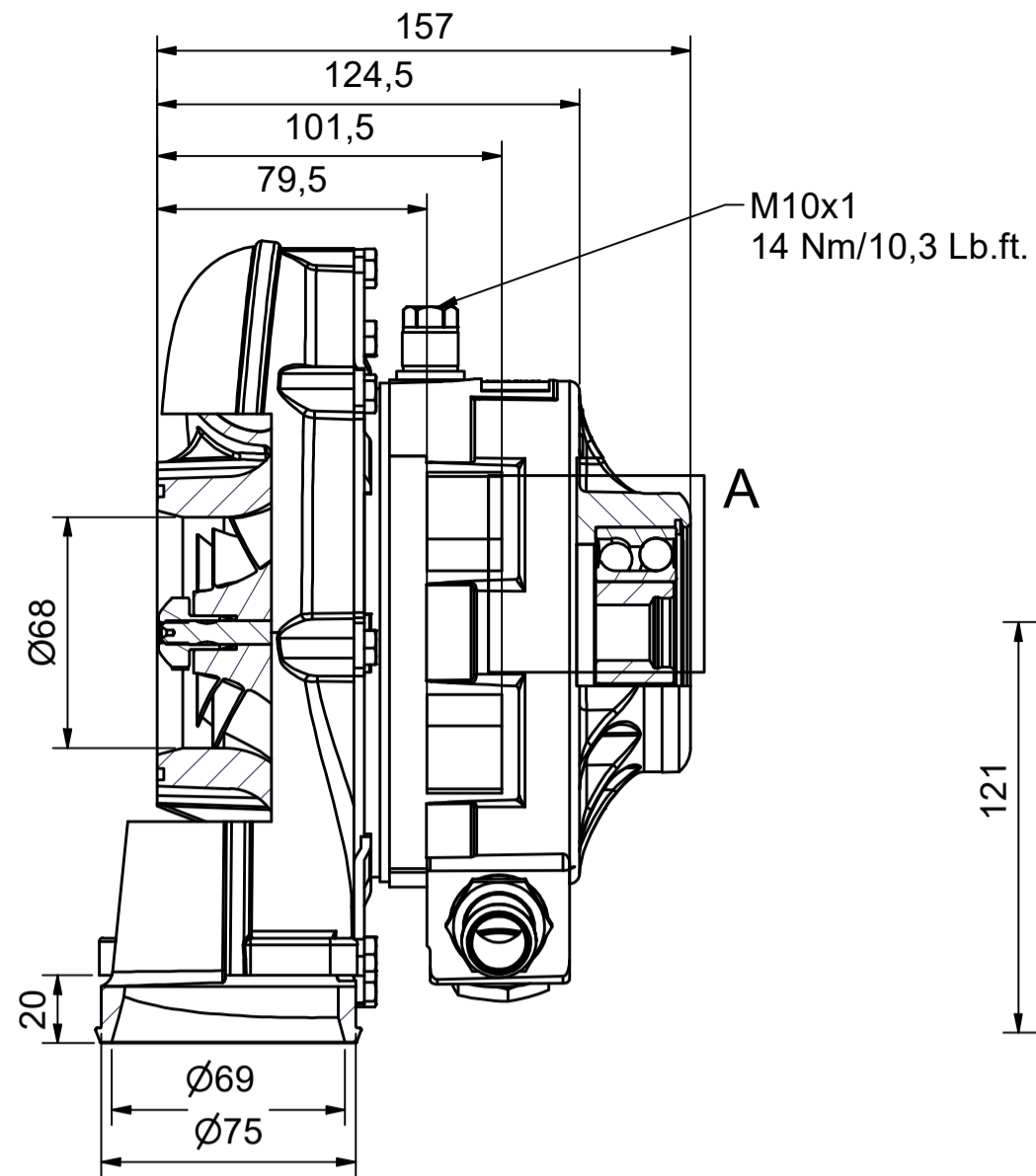

(4x) M8 25Nm/ 18.4 Lb. ft. benötigt 3 Befestigungspunkte auf Vorder- und Rückseite requires 3 mounting points on front or back

A (2:1) Antrieb drive

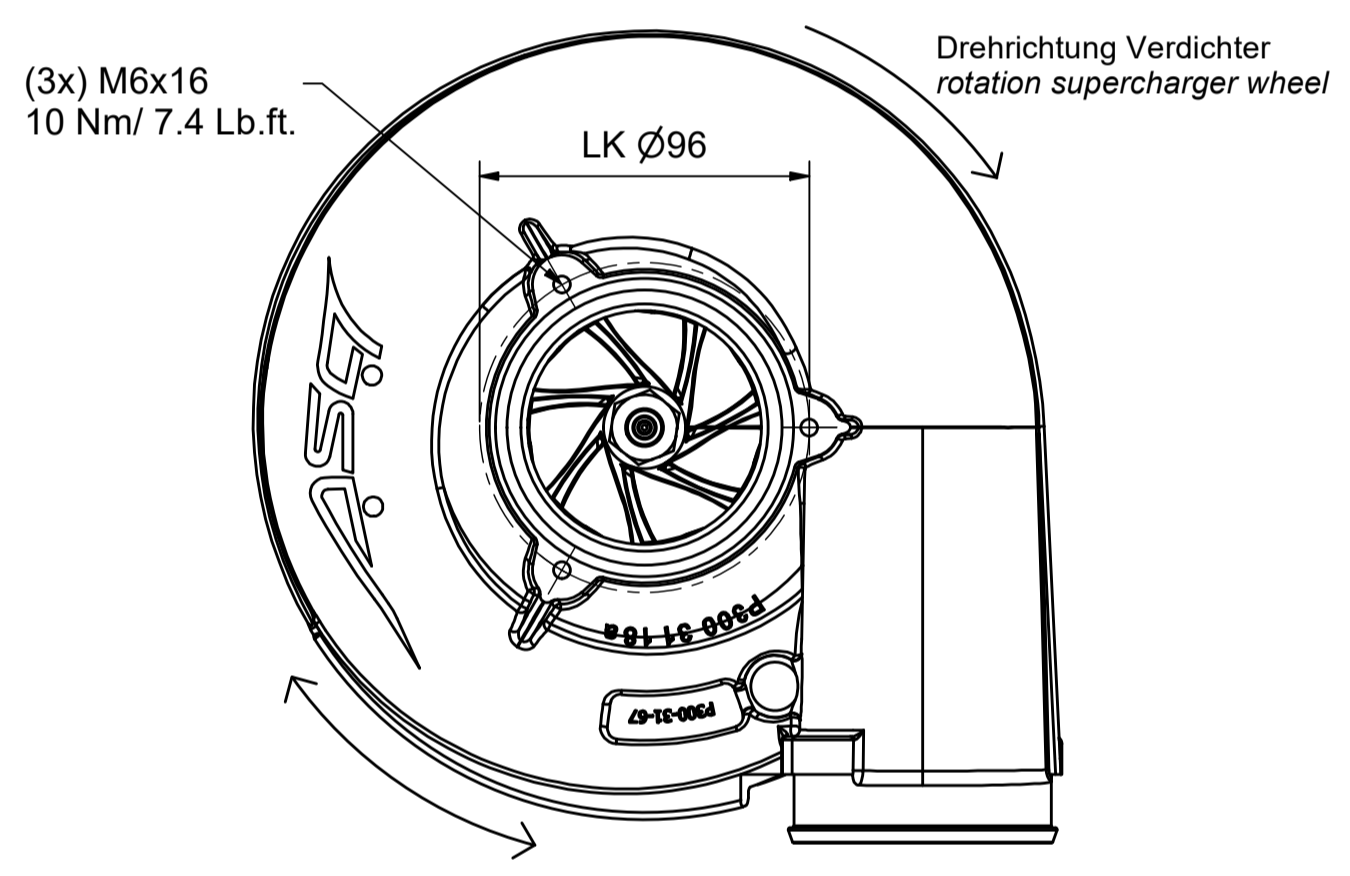
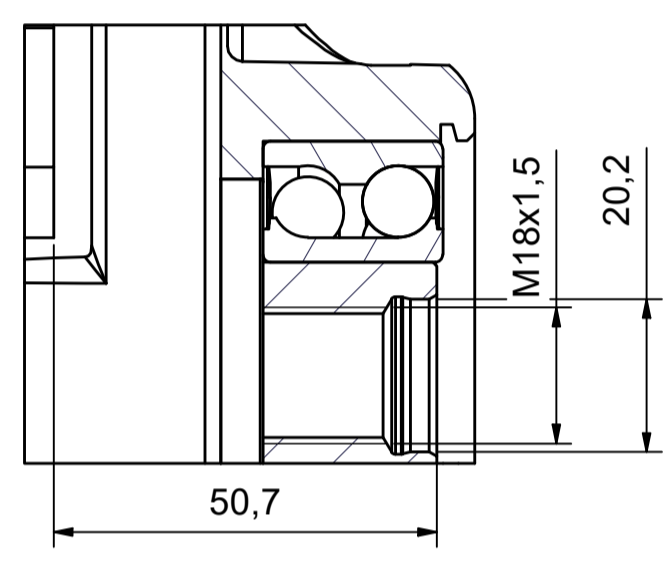

Position Verdichteraustritt ist frei um 360° drehbar  
supercharger outlet can be rotated 360°

Gewicht weight	5,9 kg
Innere Übersetzung inner gear ratio	1:15
Ölvolumenstrom (übliche Motorenöle) oil volume flow-usual engine oil	1,2 - 1,6 l/min
Min./Max. Öleintrittstemperatur min./max. oil inlet temperature	-40°C/105°C
Nenn Drehzahl rated speed	105.000 1/min
Max. Luftmasse max. air pressure flow	2050 kg/h
Max. Druckverhältnis p2/p1 max. pressure ratio	3,5
Massenträgheitsmoment mass moment of inertia	39.000 kgmm <sup>2</sup>

Verdichterkennfeld flow chart T1-520

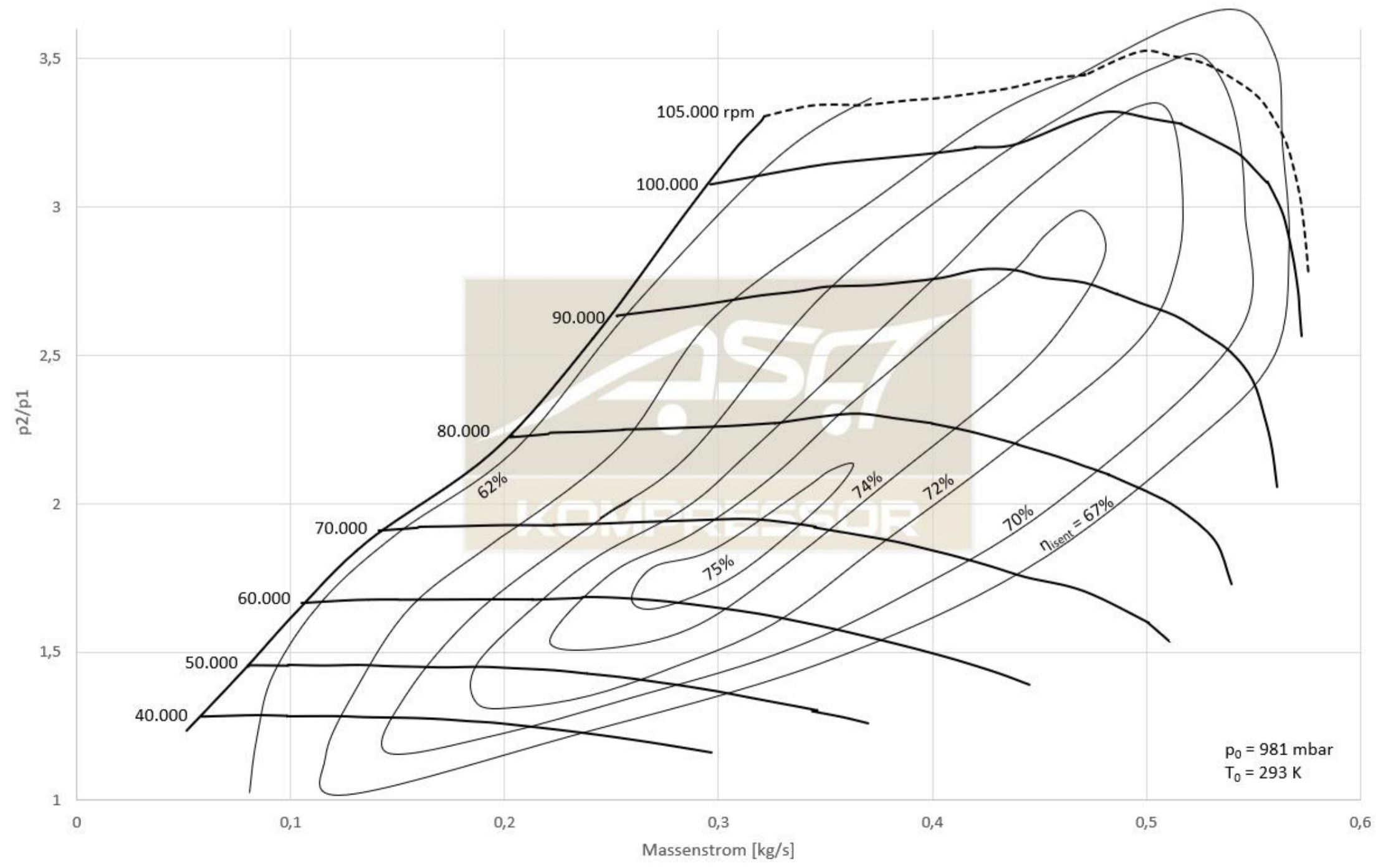

# Datenblatt data sheet