

Kompressor T3-313

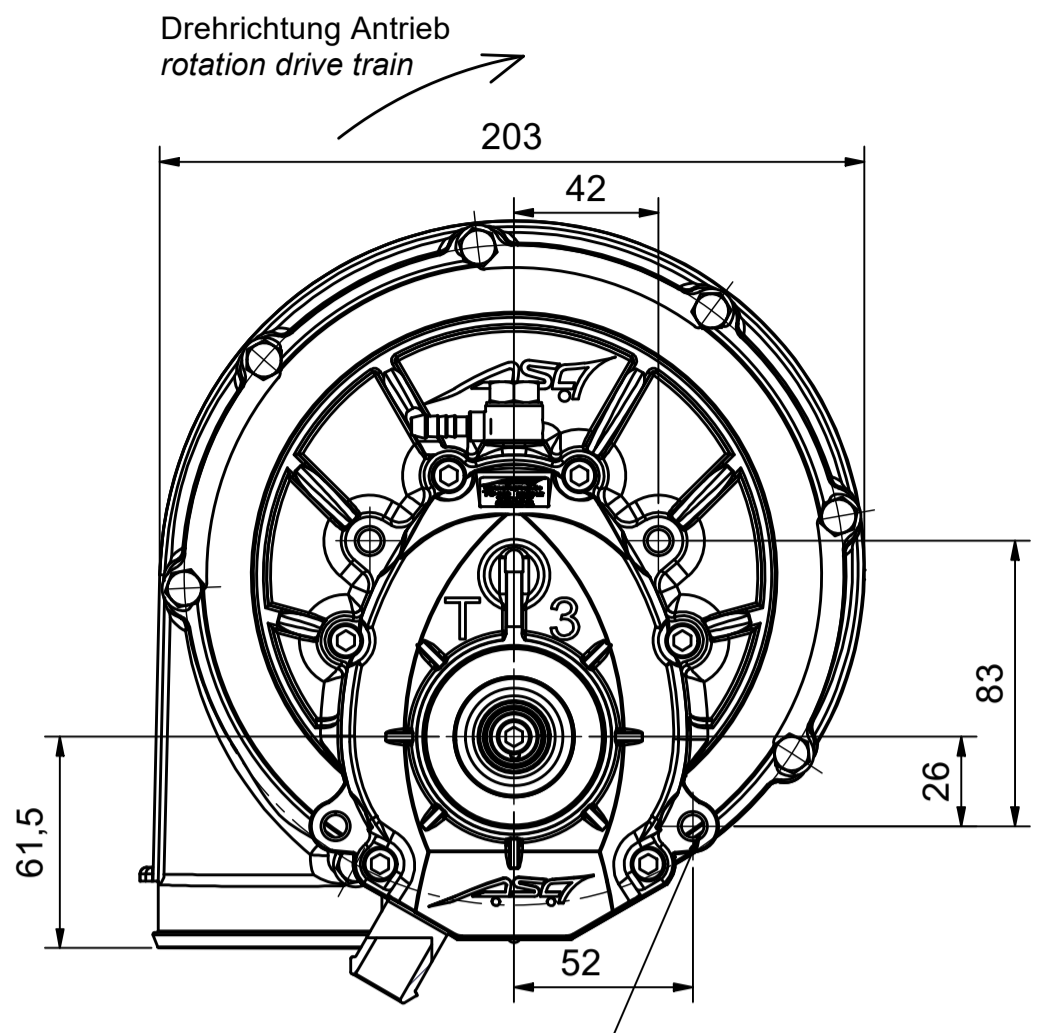

www.asa-kompressor.de

P300-00-37

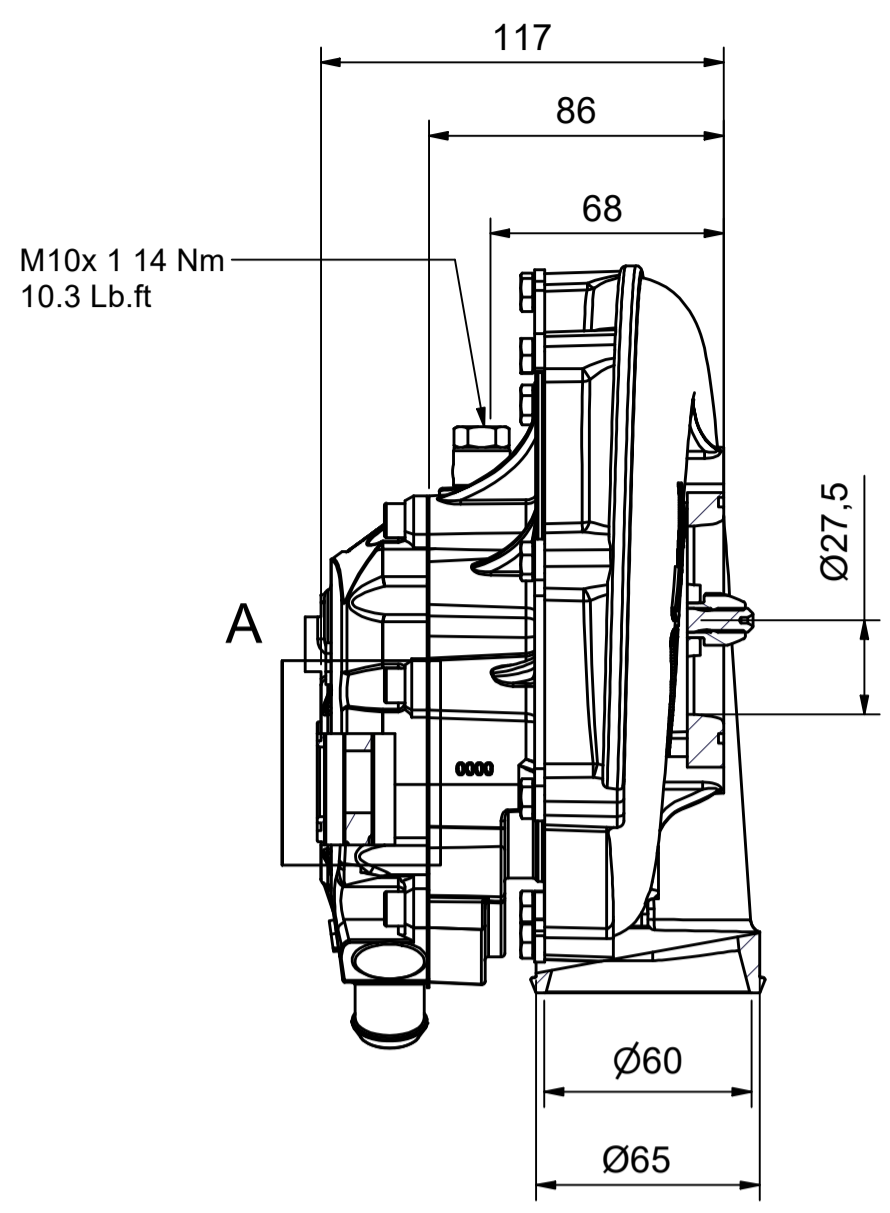

A (2 : 1)
Antrieb
drive

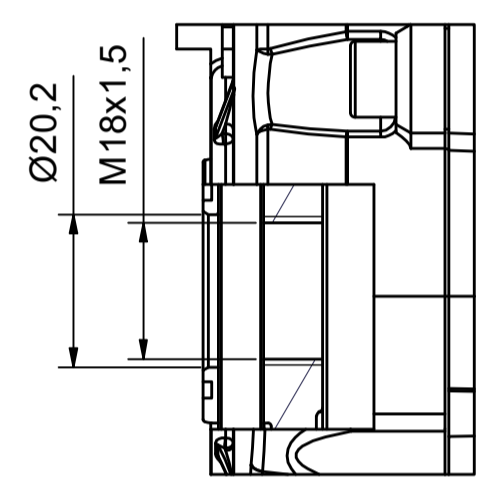

(4x) M8
25 Nm/18.4 Lb.ft.
erforderlich 3 Befestigungspunkte
auf Vorder- oder Rückseite
requires 3 mounting points
on back or front

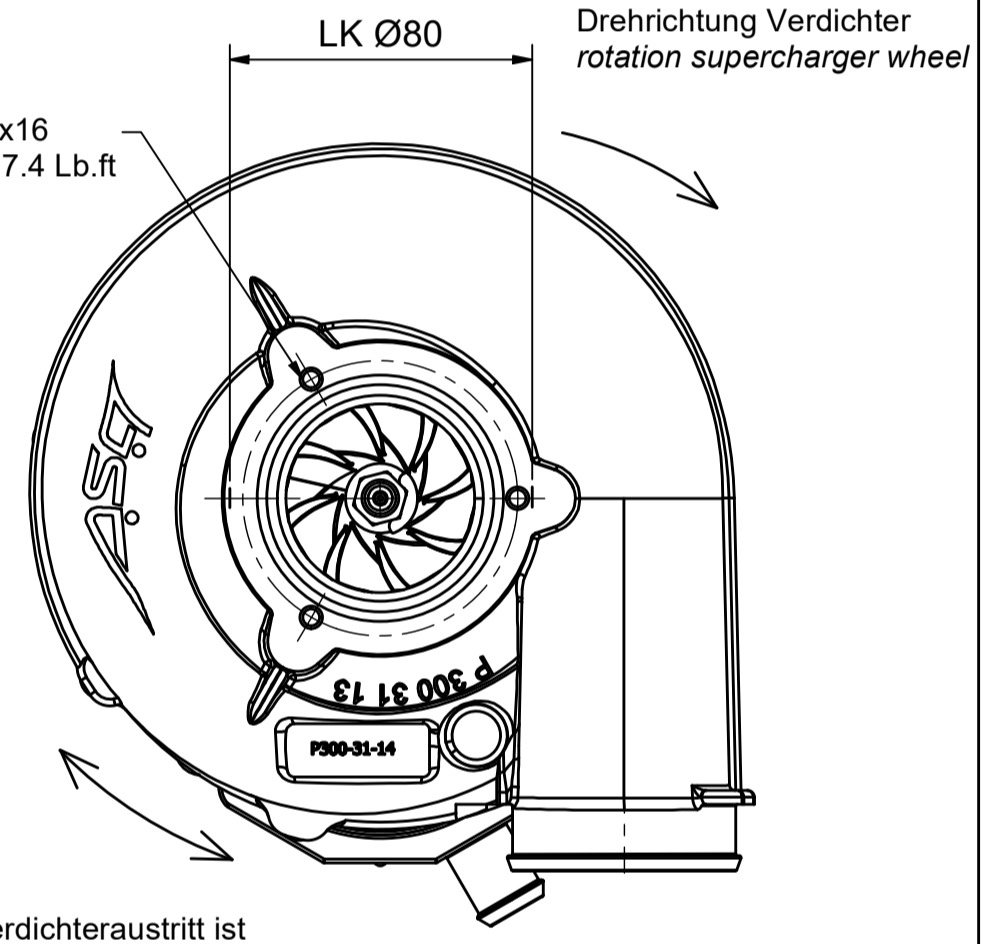

Position Verdichteraustritt ist
frei um 360° drehbar
supercharger outlet can be rotated 360°

Gewicht weight	4,1 kg
Innere Übersetzung inner gear ratio	1:10
Ölvolumenstrom (übliche Motorenöle) oil volume flow-usual engine oil	1,2 - 1,6 l/min
Min./Max. Öleintrittstemperatur min./max. oil inlet temperature	-40°C/105°C
Nenn Drehzahl rated speed	85.000 1/min
Max. Luftmasse max. air pressure flow	1.250 kg/h
Max. Druckverhältnis p2/p1 max. pressure ratio	2,0
Massenträgheitsmoment mass moment of inertia	6.100 kgmm ²

Verdichterkennfeld flow chart T3-313

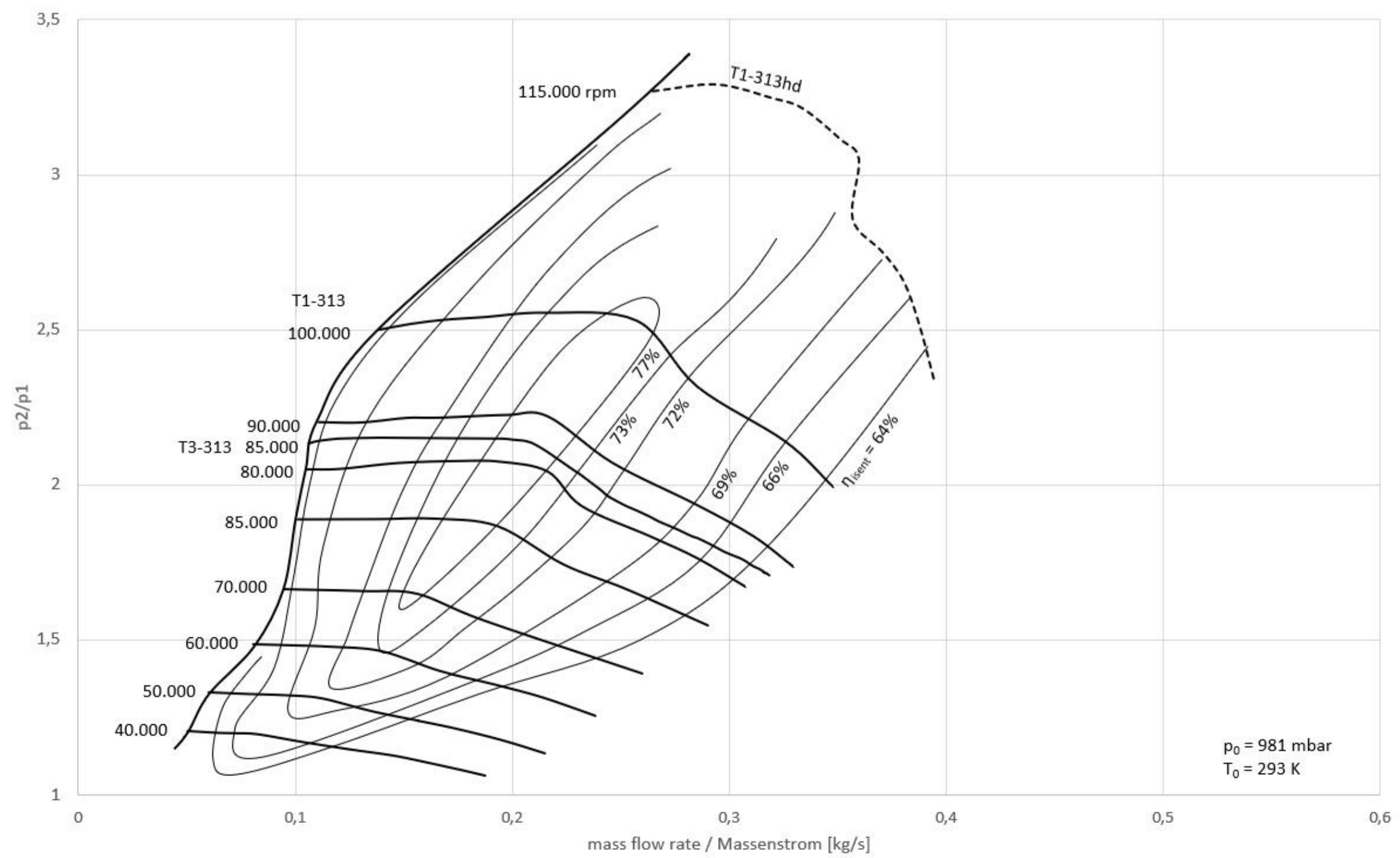

Datenblatt data sheet